

Steamboat

4/2 – 1,344 sq. ft. (approx.)

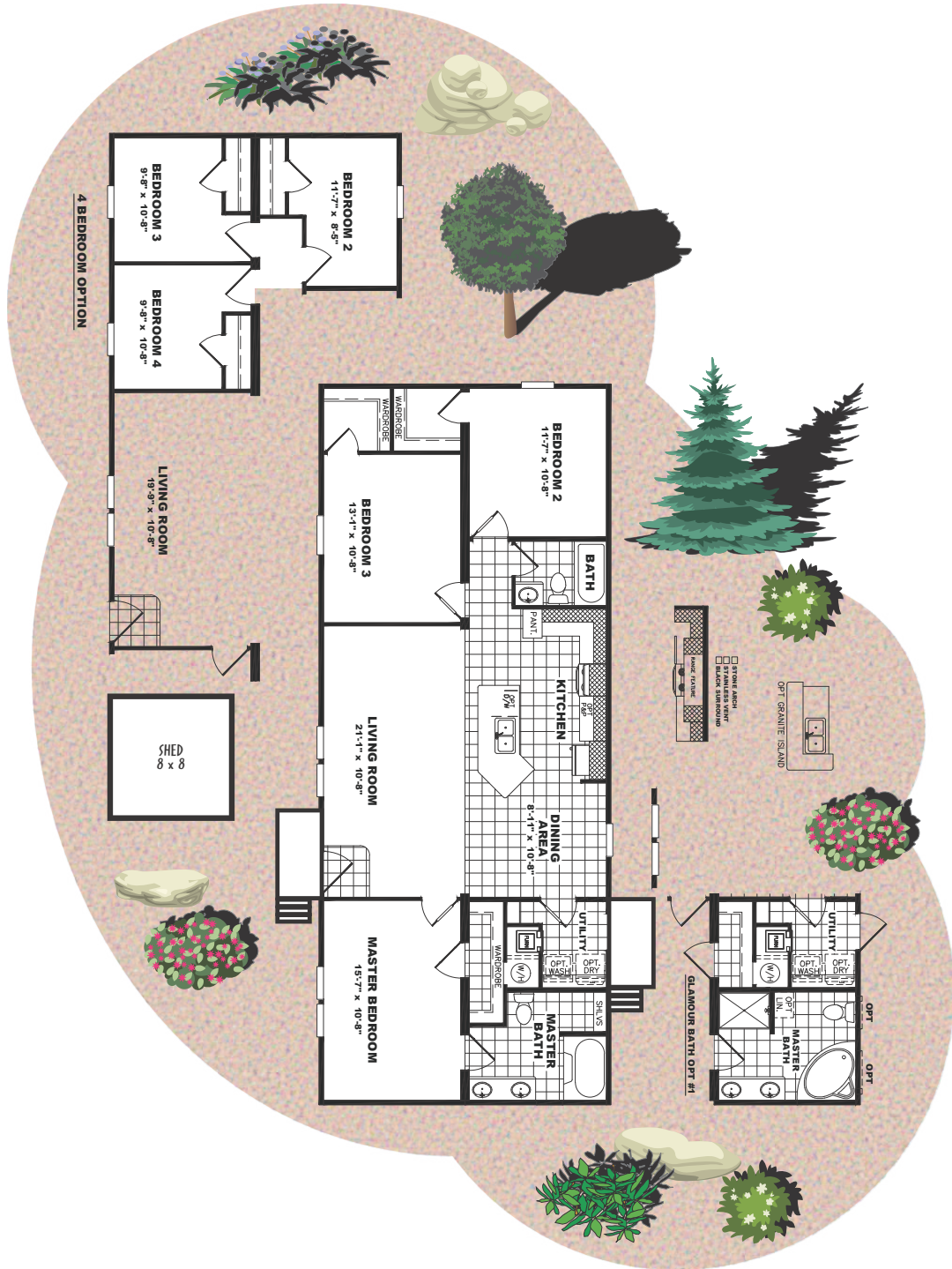

THE SPRINGS

Colorado Springs' Premier Manufactured Home Community

Individual home models may vary from the floor plan and standard specifications. Floor plans and specification may change at any time without prior notice. Please consult with our Home Specialist for specific model changes.



Home Features

Exterior

- Smart Panel Siding
- 3" Trim on all windows
- Composite Shingles
- Cement fiberboard fascia
- 6 Panel Front and Rear Doors
- Keyed alike locks & deadbolts
- 30 lb Roof Load
- 2x4 exterior and marriage walls
- Insulation R28-R22-R11
- Vinyl frame dual thermal pane windows
- Exterior receptacle, rear
- OSB floor decking
- 8' x 8' Shed
- Custom Exterior Treatments
- 8' x 5' front deck, stained treated wood
- Hardi Board 25 year skirting with metal frames
- Residential landscaping

Living Features

- 8' Flat Ceilings
- 3/8" Rebond carpet pad
- Upgrade carpet on tack strips
- Mini blinds throughout
- Tape and textured walls (some models)
- Textured ceilings
- Residential cove molding (some models)
- Color coordinated window valances
- Accent wall
- Embossed wood grain interior doors
- Central A/C
- Gas Furnace

Plumbing/Electrical

- 100amp electric
- 30 gallon electric water heater
- Master whole house shut off valve
- Quest-Pex plumbing
- Smoke and Carbon Monoxide detectors
- Light in Dining Room

Kitchen/Utility Room

- Upgrade GE black appliances
- 18' GE FF refrigerator
- 30" GE gas range
- GE Potscrubber dishwasher
- Stainless Steel sink
- Kitchen Island
- Real wood cabinet doors

Baths

- Linoleum in both baths
- Fiberglass showers and tubs
- China sinks with pop-up valves
- Master bath window
- Towel bar and tissue holders
- Tile backsplash
- Master bath feature separate shower and tubs (some models)

The Springs

1095 Western Drive OFC, Colorado Springs, CO 80915
(719) 574-4990 | www.RobertsCommunities.com



THE SPRINGS

Colorado Springs' Premier Manufactured Home Community

Individual home models may vary from the floor plan and standard specifications. Floor plans and specification may change at any time without prior notice. Please consult with our Home Specialist for specific model changes.

